

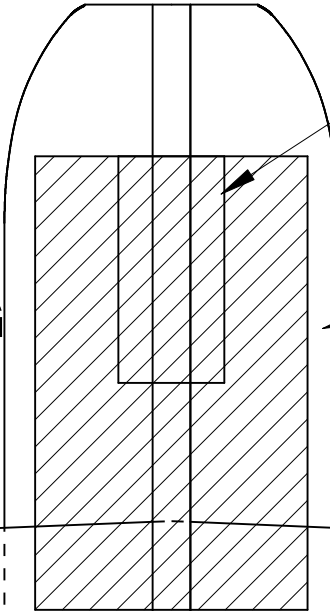

lage Pattern

Motor



Battery position to suit C of G

C of G range is from carbon tube position to 2 cm in front of it

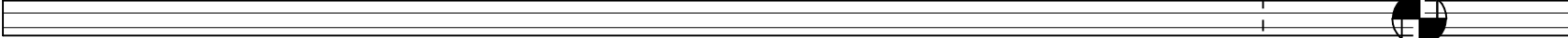

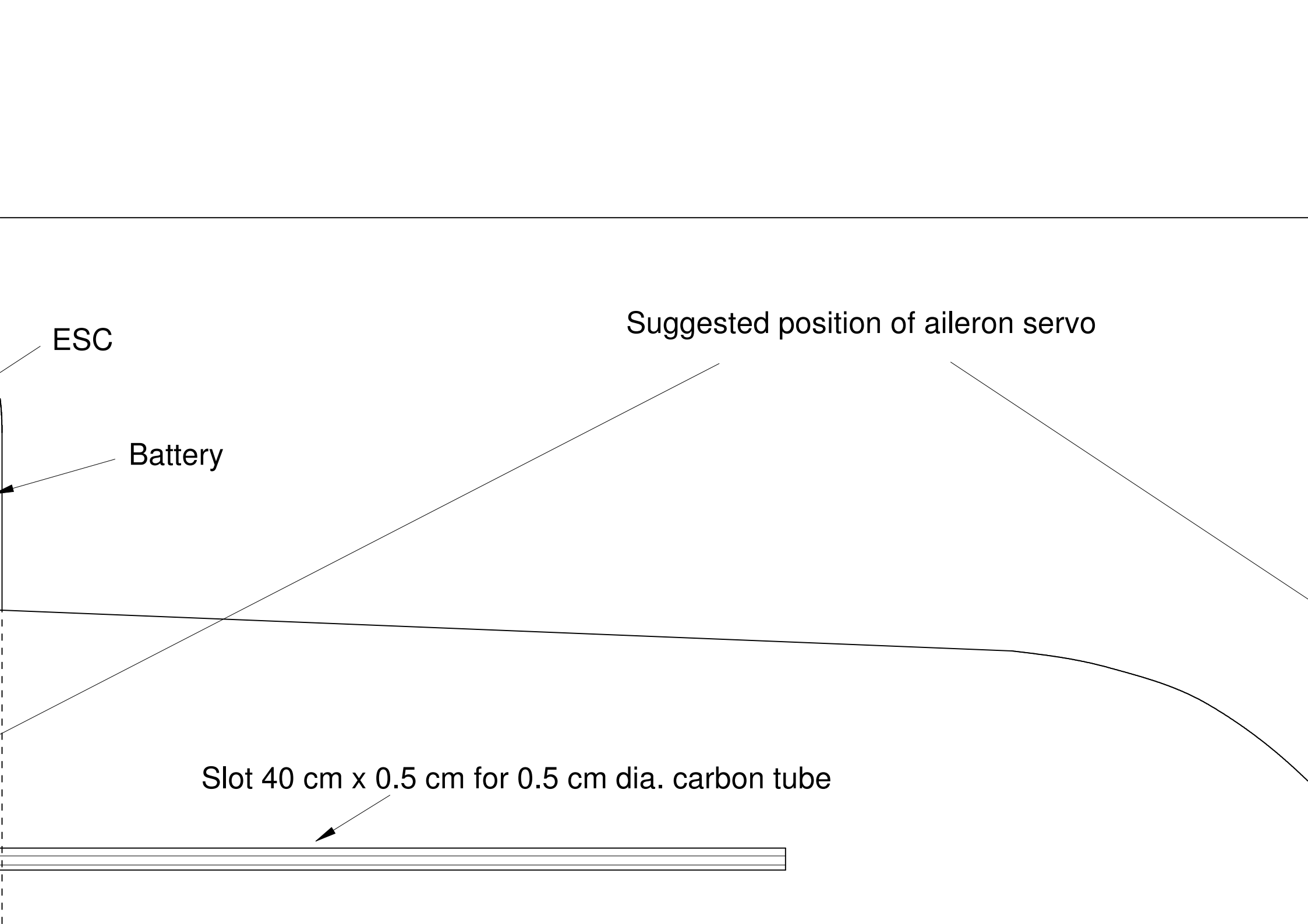

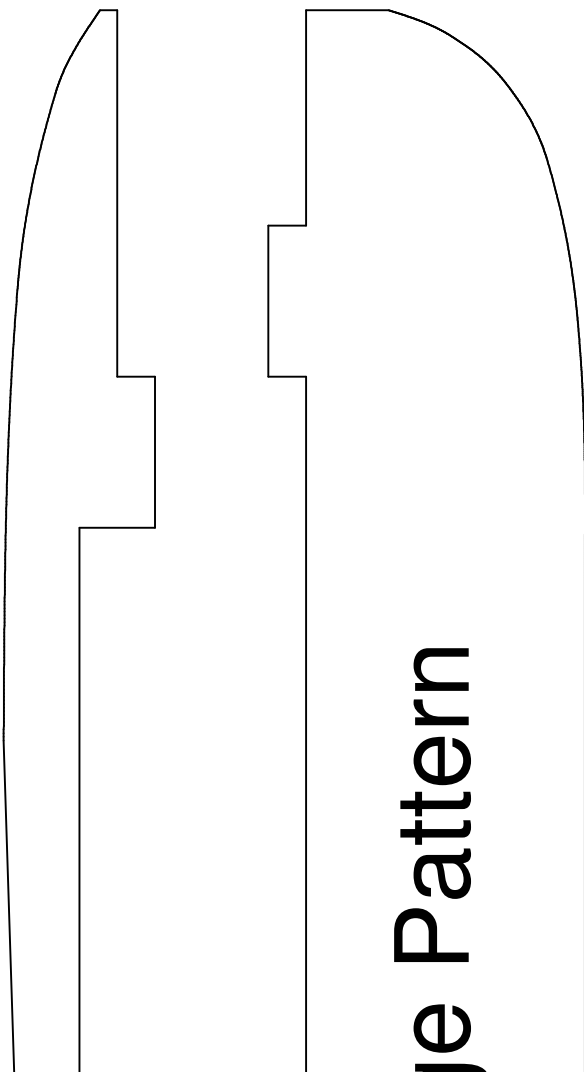
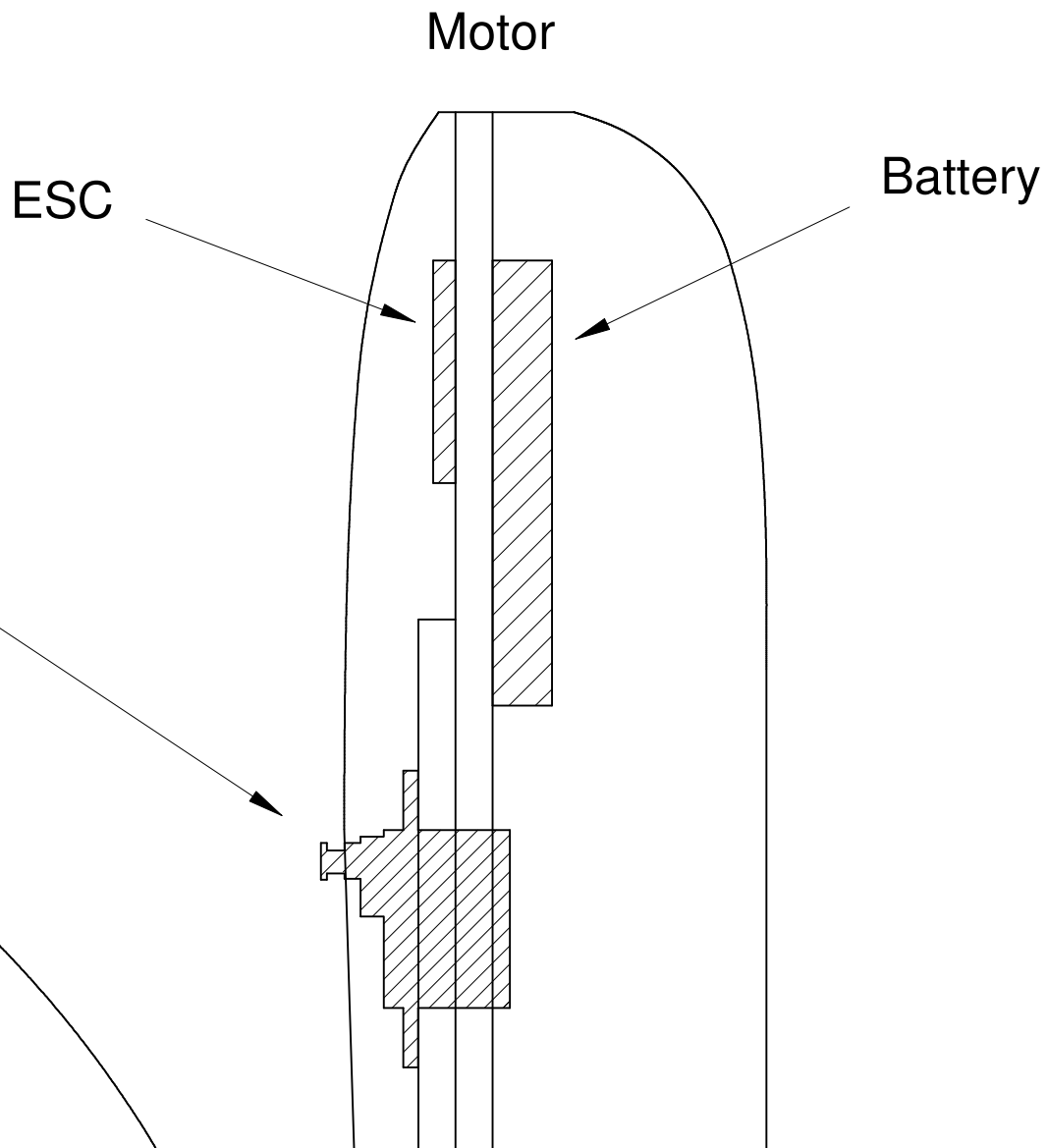

Blade Pattern

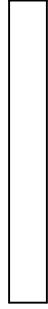

# Horizontal Fuse

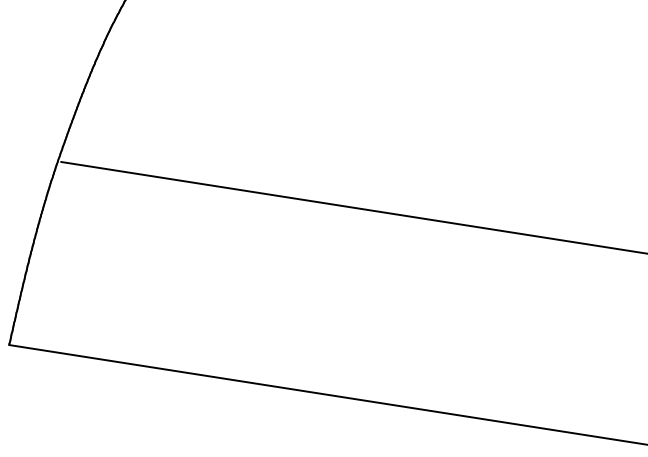

All  
are  
adj  
fus

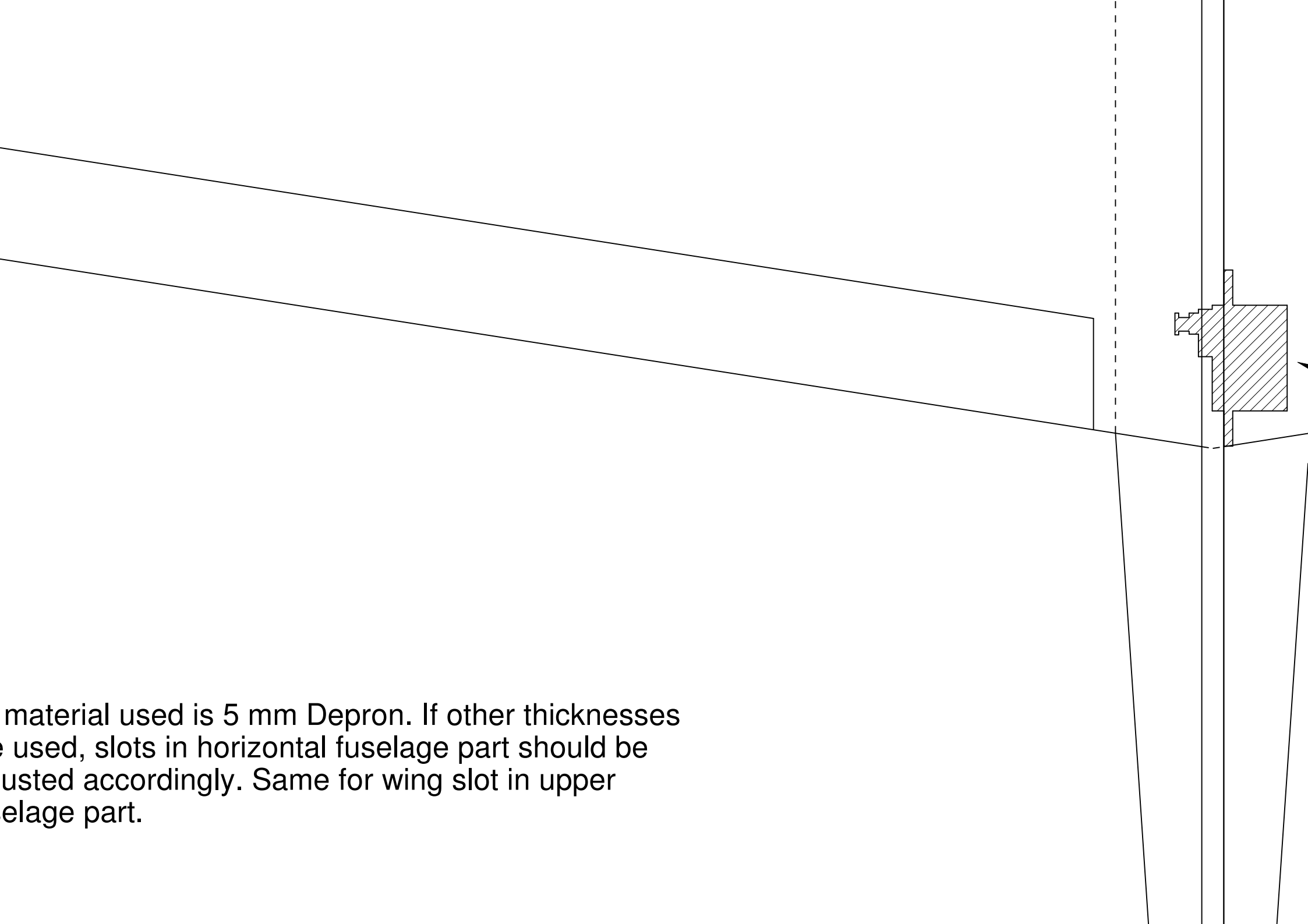

material used is 5 mm Depron. If other thicknesses  
be used, slots in horizontal fuselage part should be  
adjusted accordingly. Same for wing slot in upper  
fuselage part.

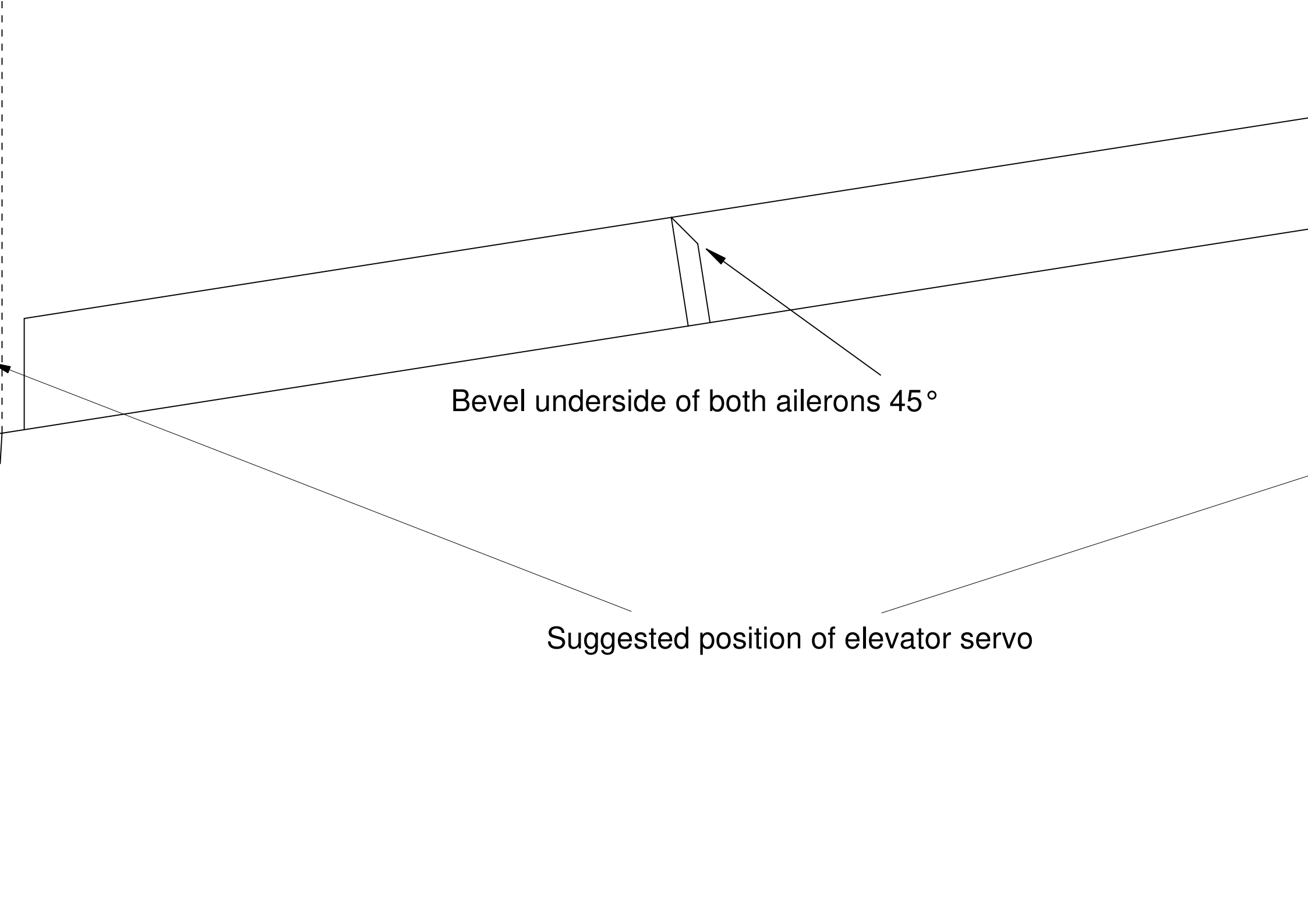

Bevel underside of both ailerons 45°

Suggested position of elevator servo

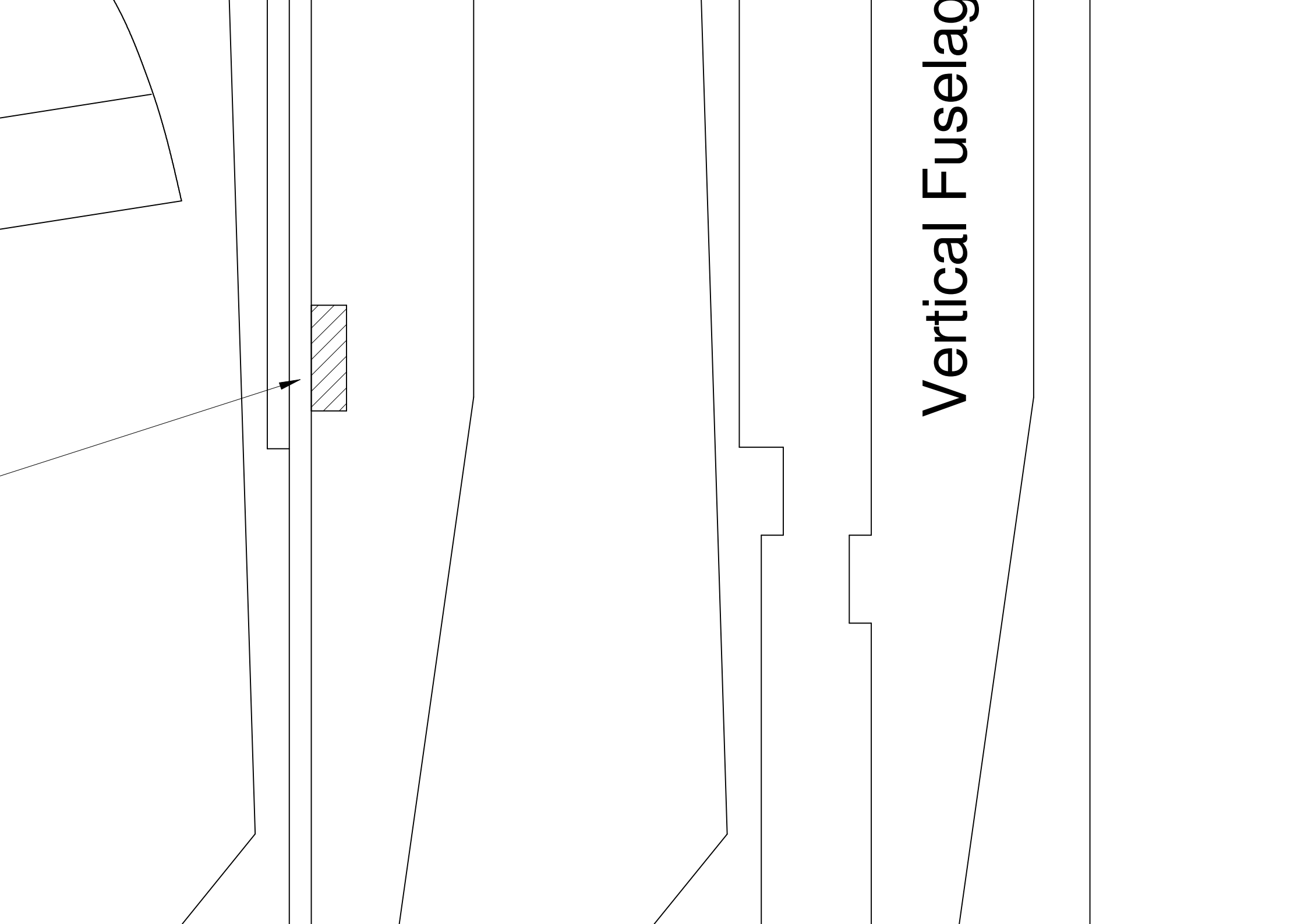

Vertical Fuselage

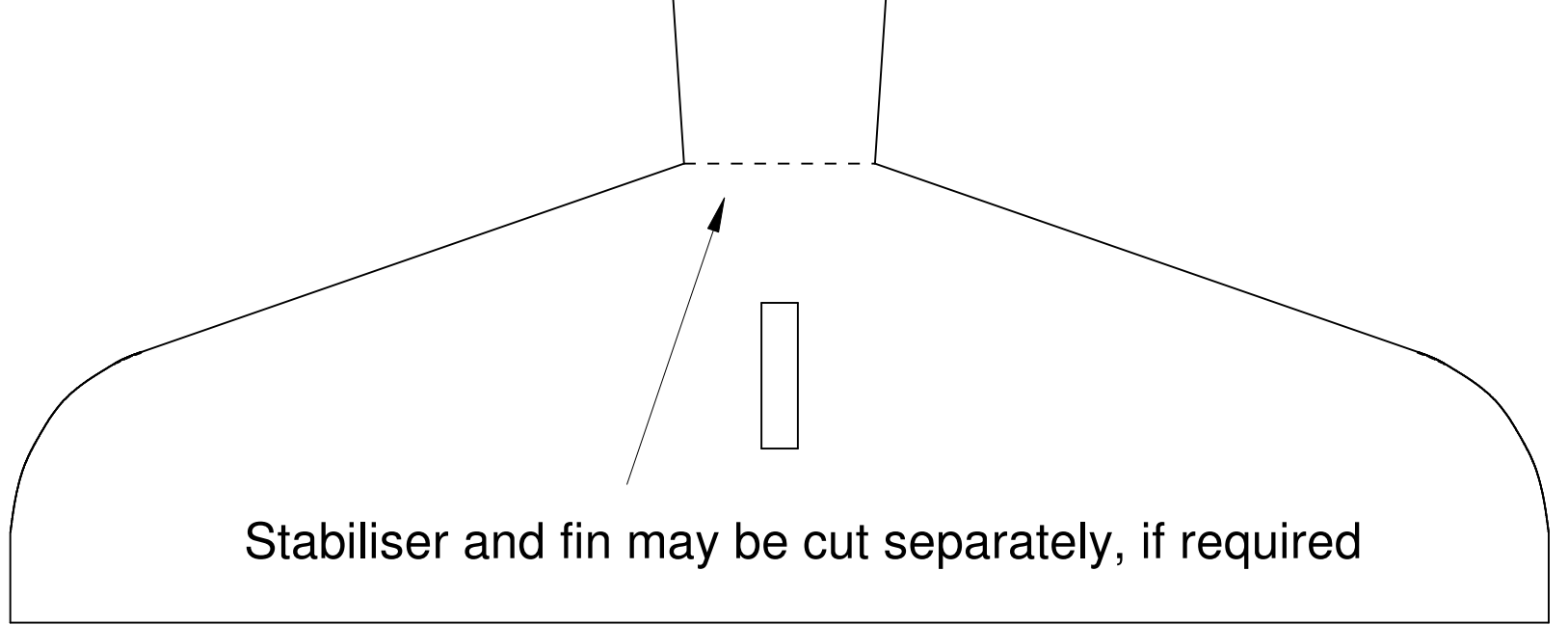

Stabiliser and fin may be cut separately, if required

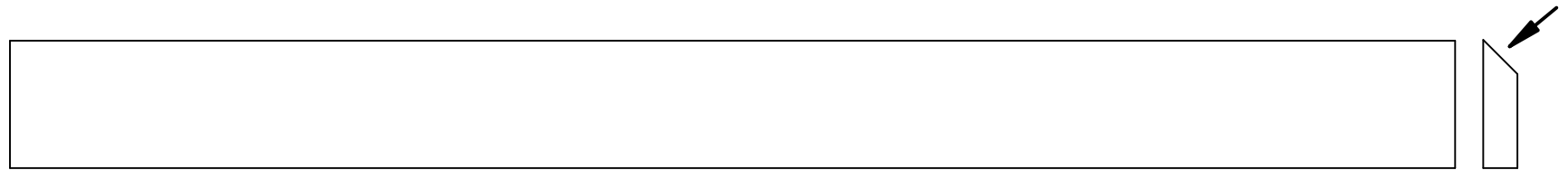

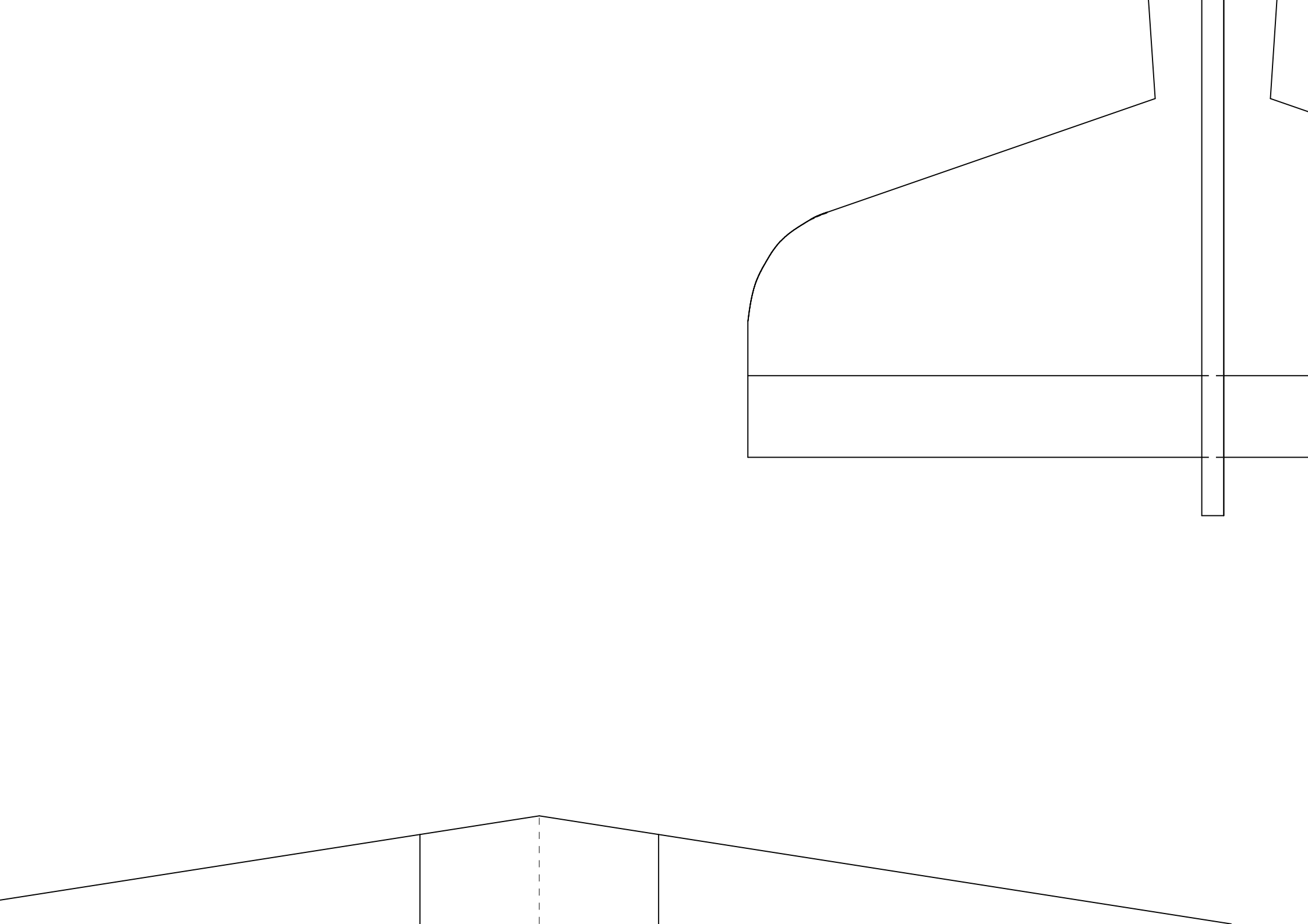

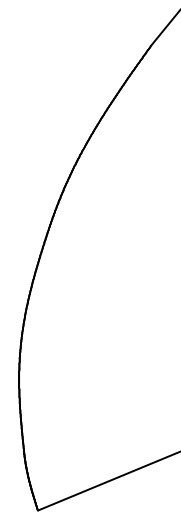
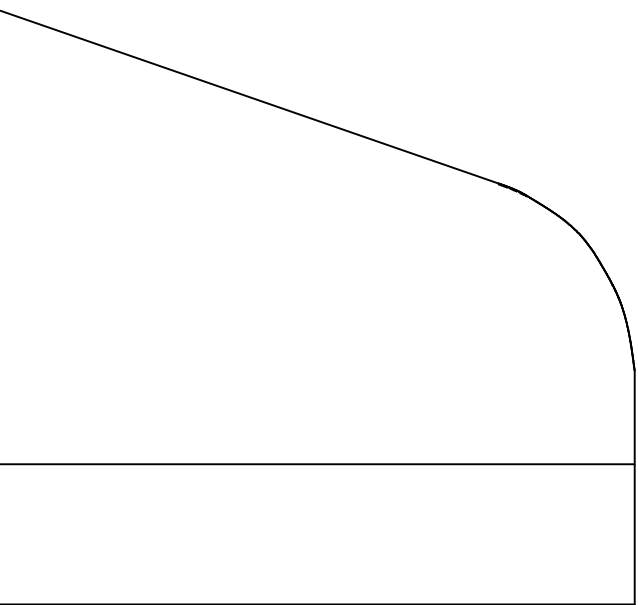

Project  
plan is  
variatio  
sturdy  
the sca  
Watt ra  
could b

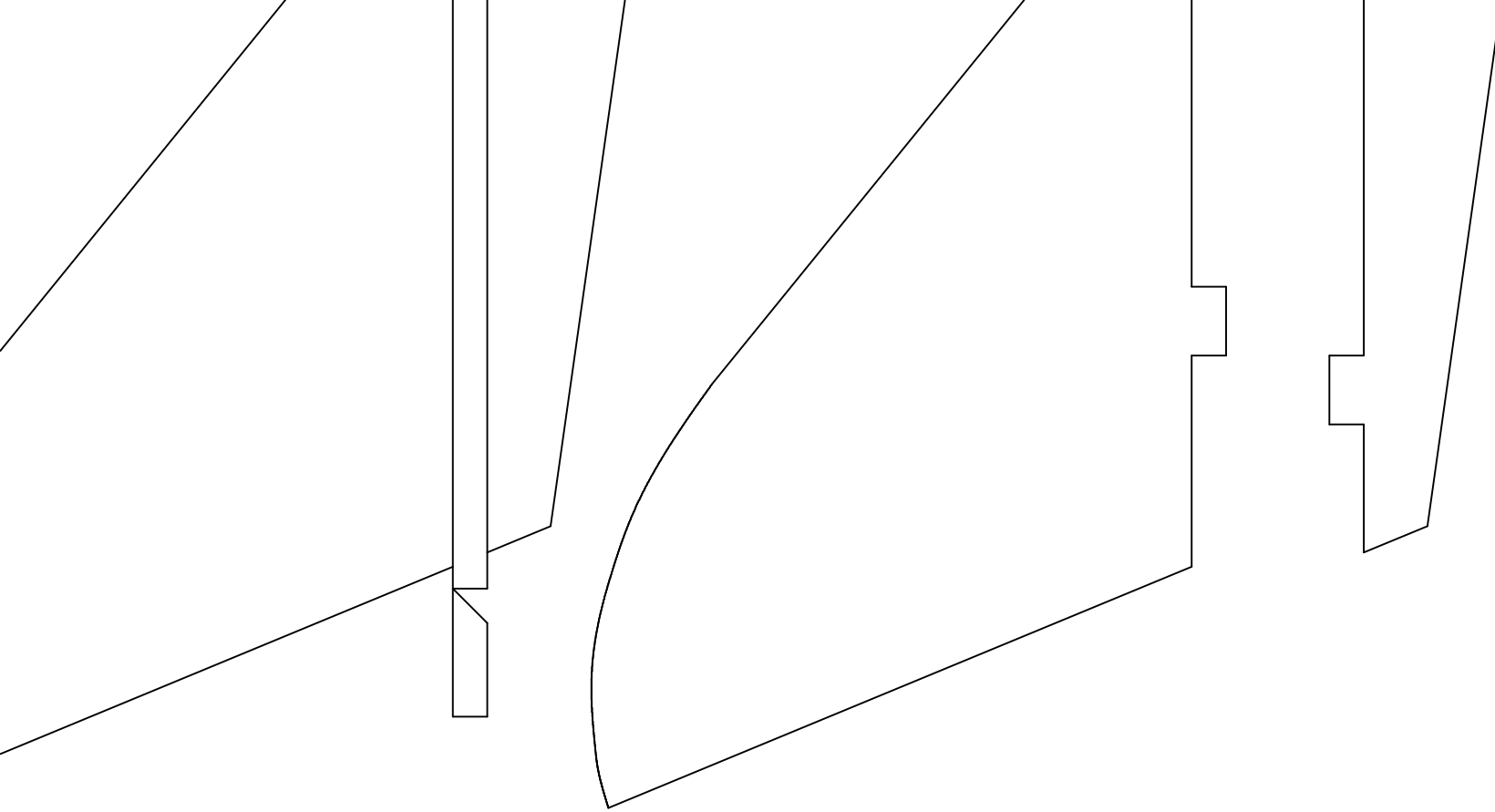

t Holidep 280 is a further development of the IMA Holiday 280. This  
intended to be a guide to building a number of versions, many  
ons are possible: made of 5 or 6 mm depron® the Holidep 280 is  
enough to be powered in the 100 Watt (or plus) range, the other end of  
ale being an all 3mm depron® version setup with a motor in the 20-30  
range. Instead of the flat -plate profile one of the Kline-Fogleman profiles  
be used.

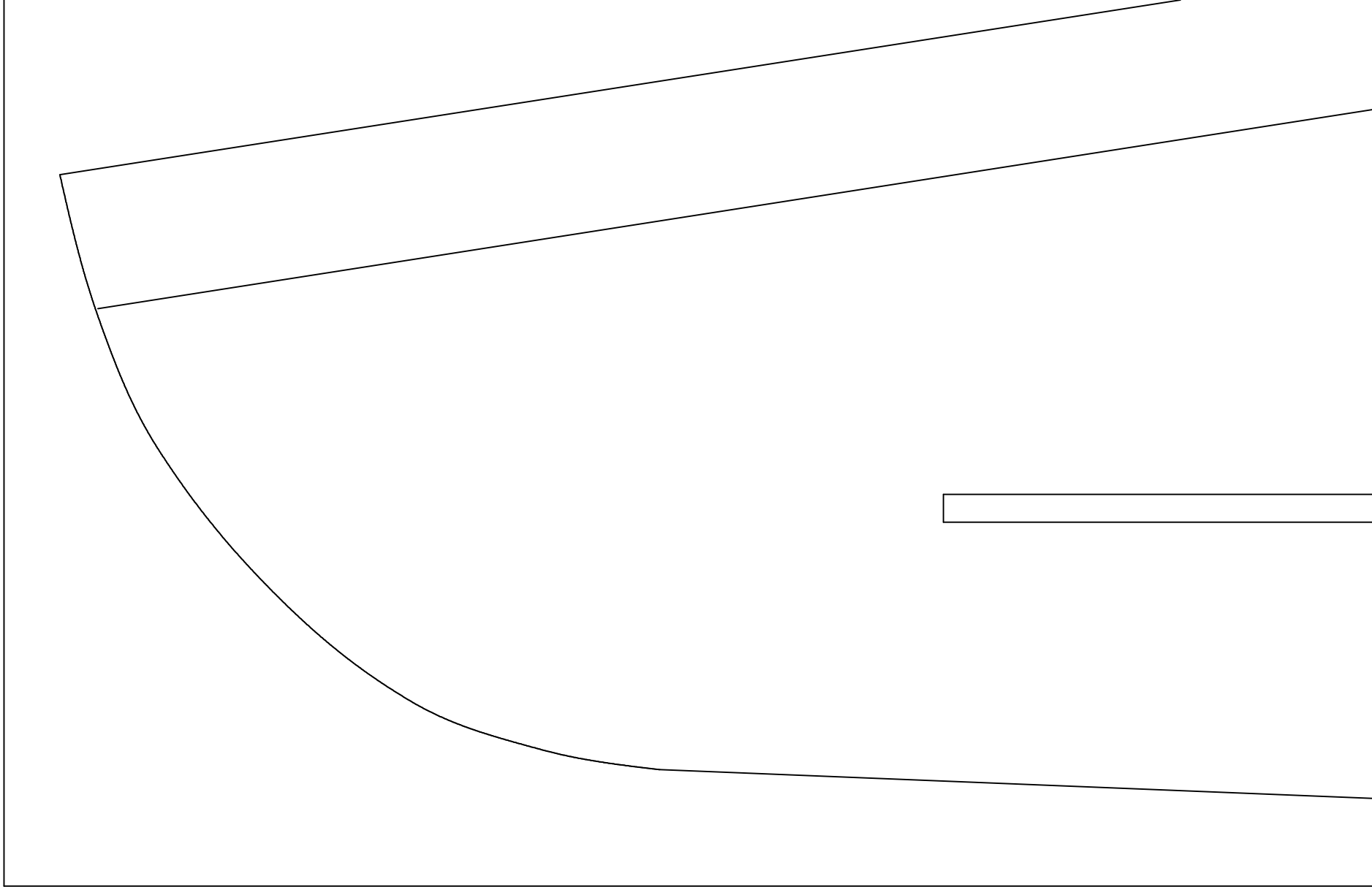

The image shows a diagram of a wing pattern. A vertical dashed line runs down the center of the page. Two horizontal solid lines are drawn across the page, one above and one below the vertical dashed line. The text "Wing Pattern" is positioned in the upper right quadrant, to the right of the vertical dashed line and above the upper horizontal line. The overall layout is simple and schematic.

# Wing Pattern

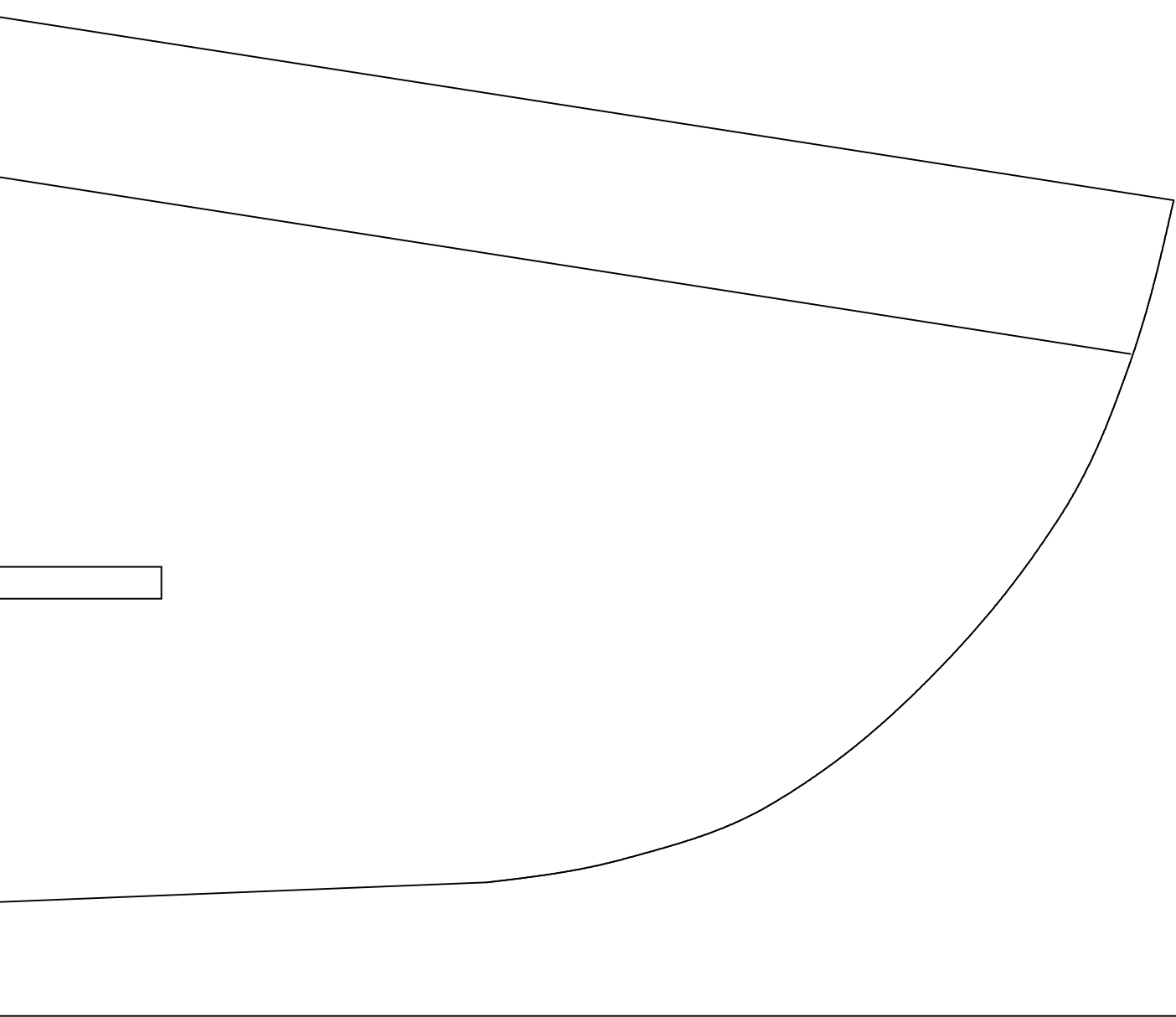

P

Material  
Power  
Properties  
Records

Design  
Department

Copy

REV

# Project Holidep 280

Material: 5 mm Depron®

Motor: From CD-Rom motor 14turn 0.4 mm or equivalent to 150 W brushless

Propeller: Gunther 125 x 110 for CD-Rom motor; propeller to suit larger motors

Recommended RTF Weight: 100 - 200 grams

Design and Drawing: Willem Bravenboer  
Depron® 5 MM used on prototype

Copyright 2008 Willem Bravenboer

REVISION V 1.1 2008-07-28