

Balance:  
When holding at rotor mast,  
rotor should be pointing  
approximately 20° down

Rotor hub, top view

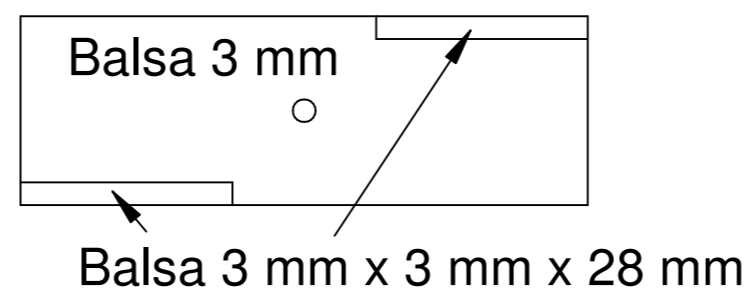

Rotorblade, 3 or 4 mm EPP

Ensure that the 3 mm x 3 mm balsa strips  
are positioned bottom left and top right  
when viewed from above. ROTOR MUST  
ROTATE CLOCKWISE WHEN VIEWED FROM  
ABOVE! Bearing is plastic tube, 2 mm inside dia.  
Tube is 12 mm long and protrudes 2 mm below hub.

Landing gear 1.2 mm piano wire

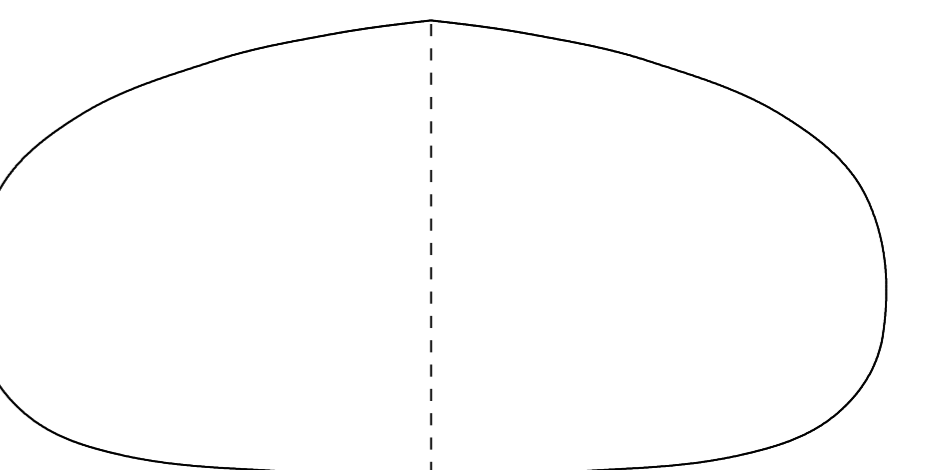

Stabiliser (May be omitted. In  
that case do not cut slot in fuselage!)

Glue Rotor mast to left side of fuselage!

Motor: 7 grams outrunner  
Battery: 2S250 - 2S300  
Servo: 3.7 g or 4.8 g  
Use lightest equipment possible!

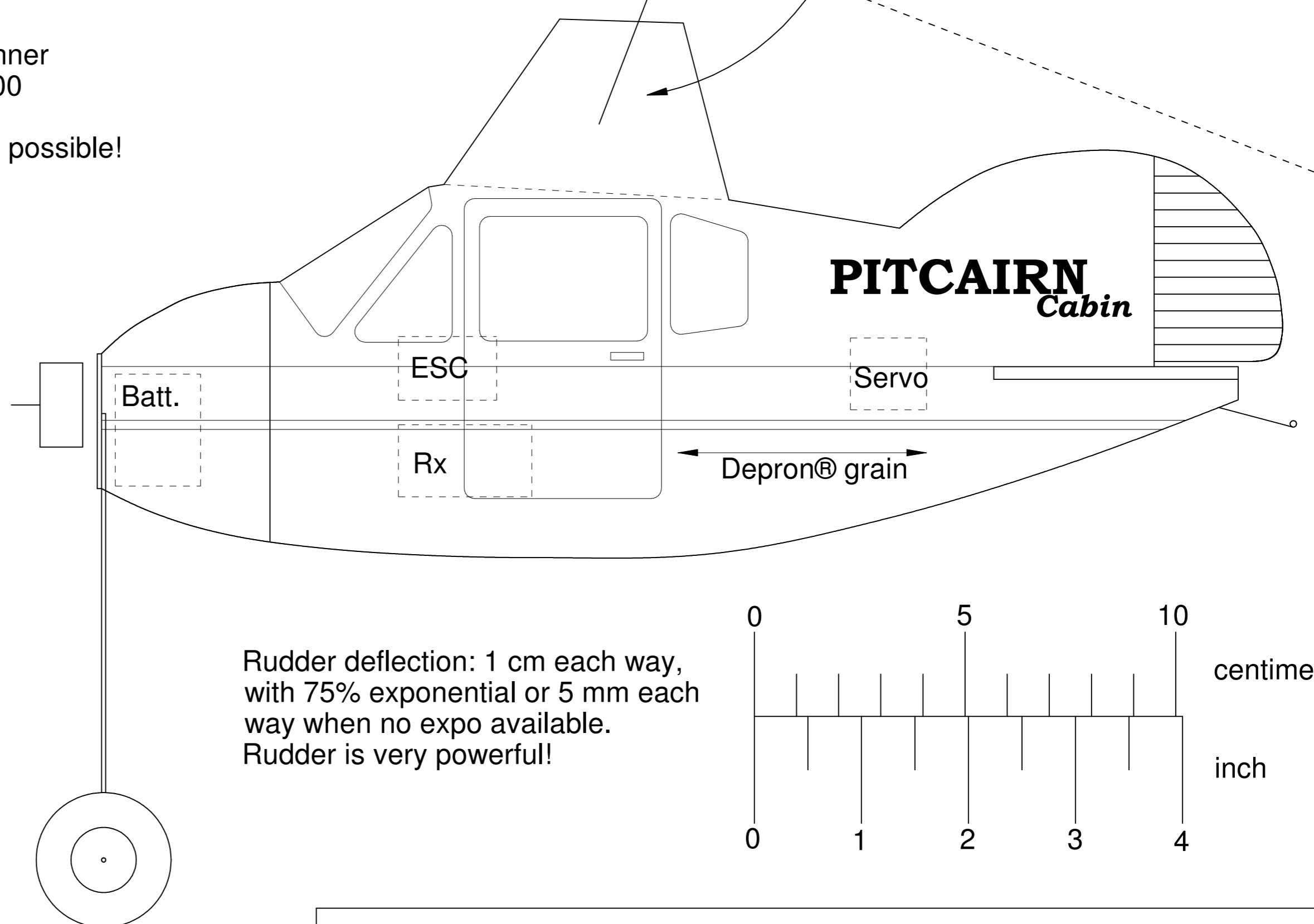

Rudder deflection: 1 cm each way,  
with 75% exponential or 5 mm each  
way when no expo available.  
Rudder is very powerful!

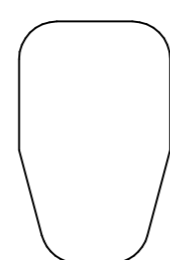
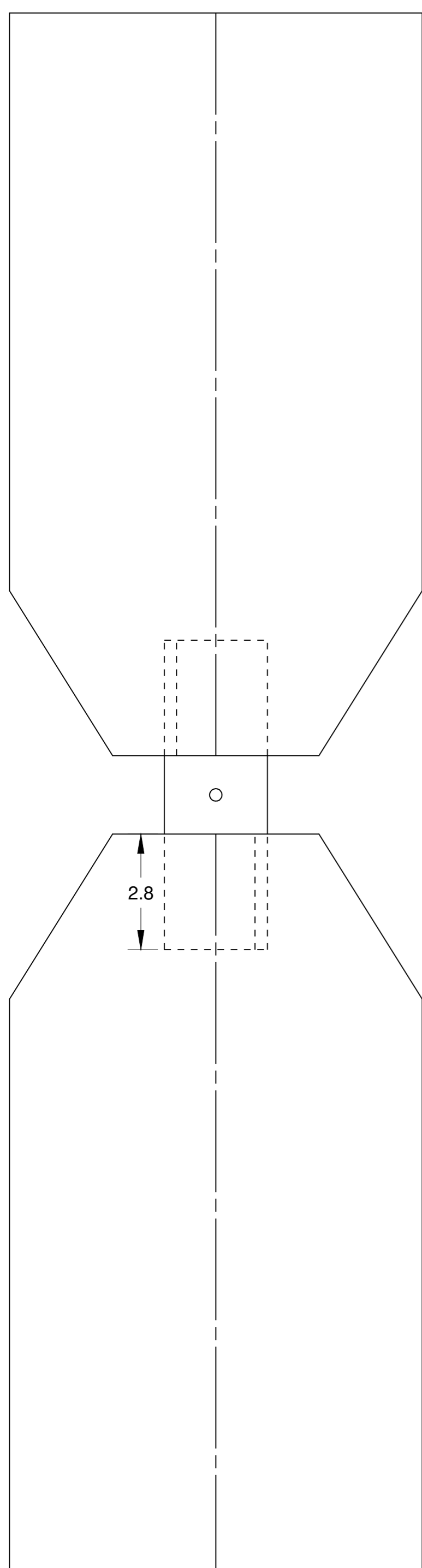
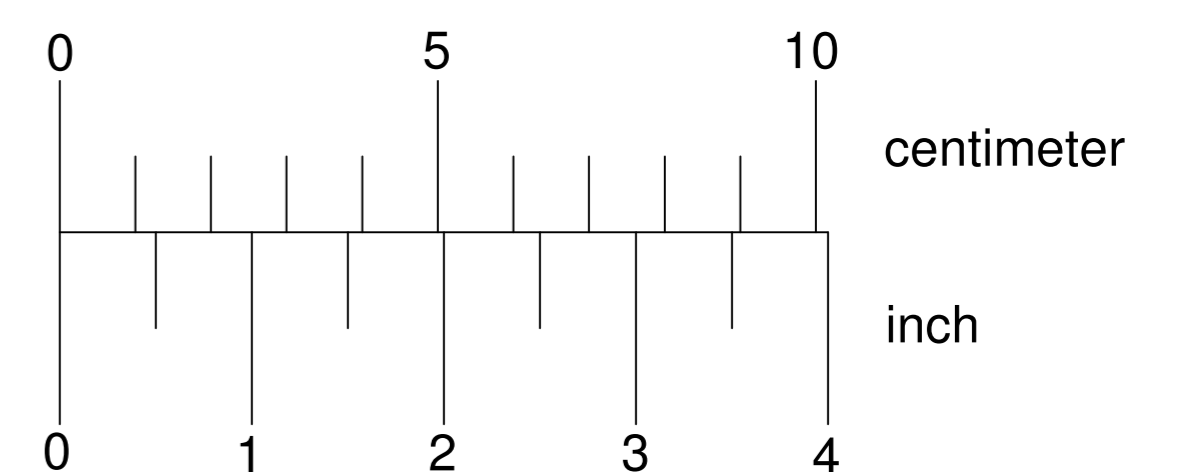

Motormount 1 mm plywood

# Micro Pitcairn Cabin

A small, easy to build and very easy to fly autogyro with an extremely high fun factor. 2 Ch. required (throttle and rudder). Target weight approximately 65 grams ready to fly.

Based on a design by Al Foot

Drawing: Willem Bravenboer

© Willem Bravenboer

REVISION V 2.0 2009-03-02